

ÜBERSICHTSZEICHNUNG

ASSEMBLY DRAWING

GHOST



HYB LECTOR 6.7 & 4.7(MY20)

2019-07-19

V01

ÜBERSICHTSZEICHNUNG

ASSEMBLY DRAWING

GHOST

Hinweis: Bei den Schrauben muß mittelfeste Gewindegewissung verwendet werden.
Rote Flächen müssen gefettet werden.

note: use medium strength screw lock for screw threads.
red surfaces has to be greased.

Hinweis: Kabelführungen modellabhängig
note: cableguides depends by model

Hinweis: Gabel nur bei HYB LECTOR X verbaut!
note: fork just mounted at HYB LECTOR X!

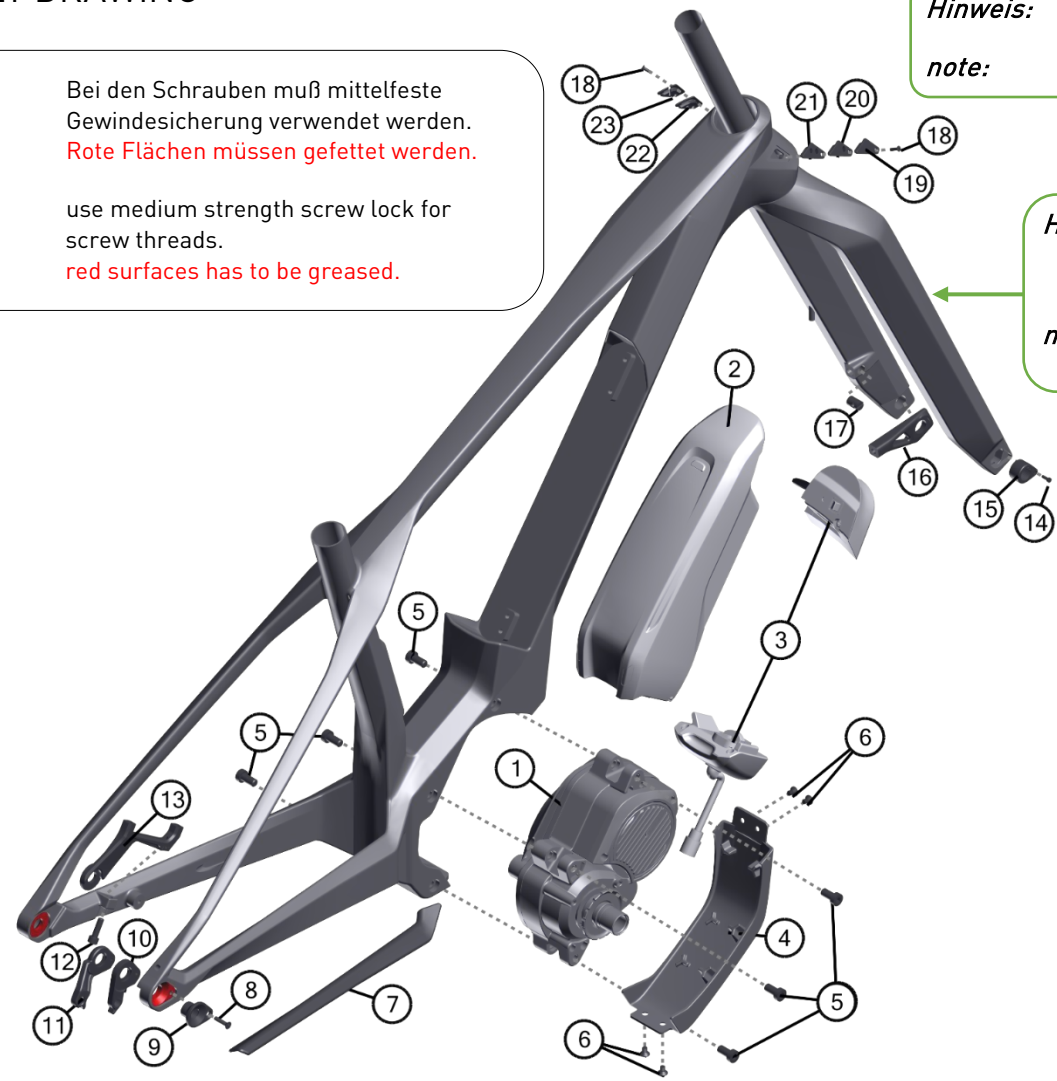

FACT SHEET:

SHOCK LENGTH:	----
SHOCK HARDWARE:	
TOP:	----
BOTTOM:	----
HEADSET:	
TOP:	ZS 44
BOTTOM:	ZS 56
SEATPOST DIAMETER:	31.6 MM
CLAMP INNER DIAMETER:	34.9 MM
BOTTOM BRACKET:	----
KICKSTAND:	----
ISCG STANDARD:	ISCG05



ÜBERSICHTSZEICHNUNG

ASSEMBLY DRAWING

GHOST

BOM-ID	Description	Specification	Torque	Item no.	QTY
1	Drive Unit DU-E8000			EL0222	1
2	Battery, BT-E8010			EL0159	1
3	Battery Mount & Battery Lock			EL0158 & EL0155	1
4	Engine protection			FRPR0022	1
5	DU Screw	Hex 5 - M8 x 20mm (8.8)	25 Nm	SM1616	6
6	Engine protection screw		6 Nm	FRSC0022	4
7	C/S protector			SM1669	1
8	Flat Head Screw M4	T15 - M4 x 20mm	0,8 Nm	FRSC0061	1
9	Hanger Mount			FRNT0061	1
10	SRAM Hanger (B2)			FRHG0021	1
11	Shimano Hanger (B1)			FRHG0022	1
12	Post Mount Screw	T30 - M6 x 26mm	8 Nm	SM1372	1
13	Disc Brake Mount			FROT0013	1
14	cylindrical flat head Screw	Hex 3 - M3 x 8mm	0,5 Nm	FRSC0027	1
15	hanger mount			FRNT0002	1
16	Brake Mount			FROT0001	1
17	Disconnect brake mount nut			FRNT0006	1
18	Headtube flat Screw	T10 - M3 x 10mm		SM1524	2
19	HT cap right; no hole			SM1504	1
20	HT cap right; 1 hole; Dropper			SM1399	1
21	HT cap right 2 hole; Dropper + FD			SM1402	1
22	HT cap left; RB & RD			SM1401	1
23	HT cap left; RB & RD DI2			SM1509	1